

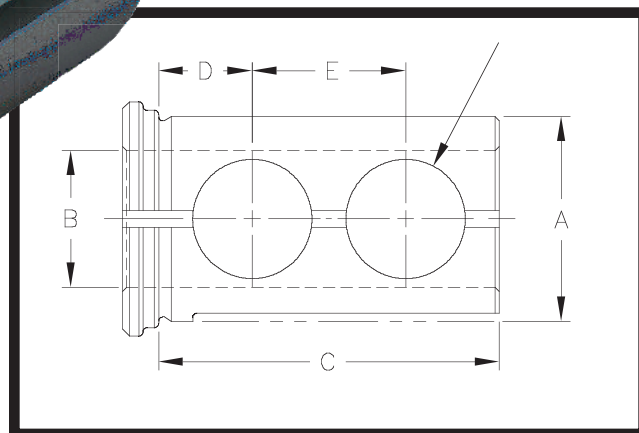

Toolholder Bushing Type “DD”

With the combination of the industry standard “B” style split bushing and “J” set screw clearance bushing design, CNC has a set a precedent with its new innovative “DD” Double Duty bushing. This new improved “DD” bushing with clearance holes and split milled flat can be used as a conventional “B” style or “J” style bushing. “Double Duty” one of CNC’s latest innovations. Select the O.D. size that fits your machine and order from the chart below.

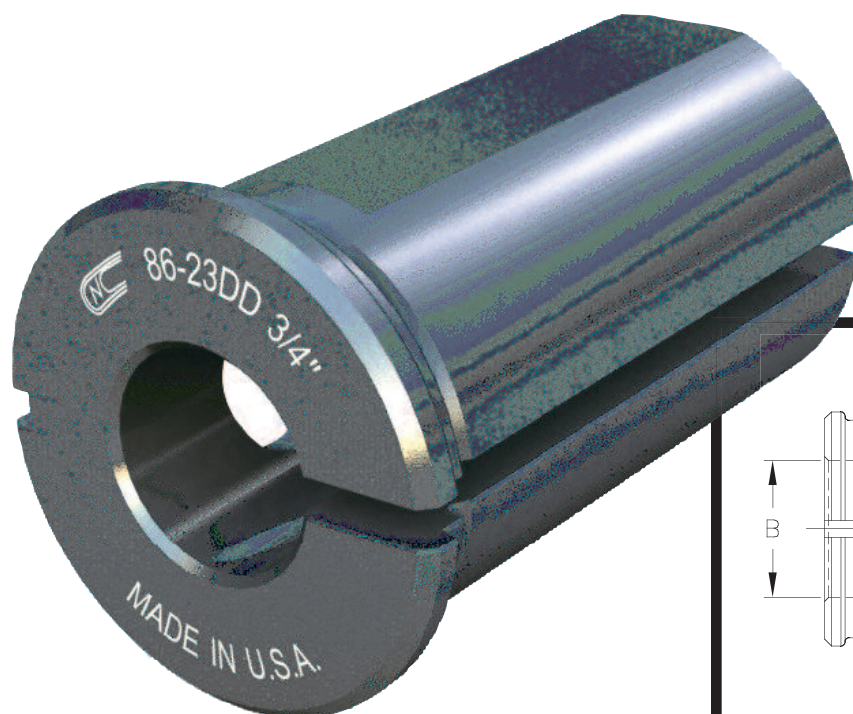

CNC PART NUMBER	BUSH DIA.		STANDARD BORE SIZES STOCKED		SPECIAL BORE SIZES AVAILABLE		LENGTH UNDER HEAD	LENGTH DIMENSIONS		HOLE SIZE	NO. HOLES
	A		B		MIN.	MAX.	C	D	E	F	
	IN.	MM	IN.	MM							
CNC 86-23DD	1½	40	⅜, ½, ⅝, ¾, ⅞, 1, 1¼	10, 12, 16, 20, 25, 32	¼	1¼	2½	1¼ ₁₆	1⅛	⅞	2
CNC 86-24DD	1¾	45	½, ⅝, ¾, ⅞, 1, 1¼, 1½	12, 16, 20, 25, 32, 40	⅜	1½	3	¾	1¼	⅞	2
CNC 86-25DD	2	50	½, ⅝, ¾, ⅞, 1, 1¼, 1½, 1¾	12, 16, 20, 25, 32, 45, 50	⅜	1¾	3½	¾	1½	1	2
CNC 86-26DD	2½	65	½, ⅝, ¾, ⅞, 1, 1¼, 1½, 1¾, 2, 2¼	20, 25, 32, 40, 45, 50	½	2¼	4	⅞	1¾	1¼	2
CNC 86-27DD	3	80	1, 1¼, 1½, 1¾, 2, 2¼, 2½	25, 32, 40, 45, 50, 60, 65	¾	2½	4½	1	2	1¼	4
CNC 86-28DD	3½	90	1½, 1¾, 2, 2¼, 2½, 3	25, 32, 40, 45, 50, 60, 65	¾	3	5¼	1¼	2½	1¼	4

*Special sizes available to fit your machine specifications: inch-metric, metric-inch, or metric-metric.

*All Orders ship standard in inch sizes. If required; please specify metric O.D. or I.D., when ordering.