

NEW! Small OD Boring Bar Sleeve

You can Now Hold Small ID Tools

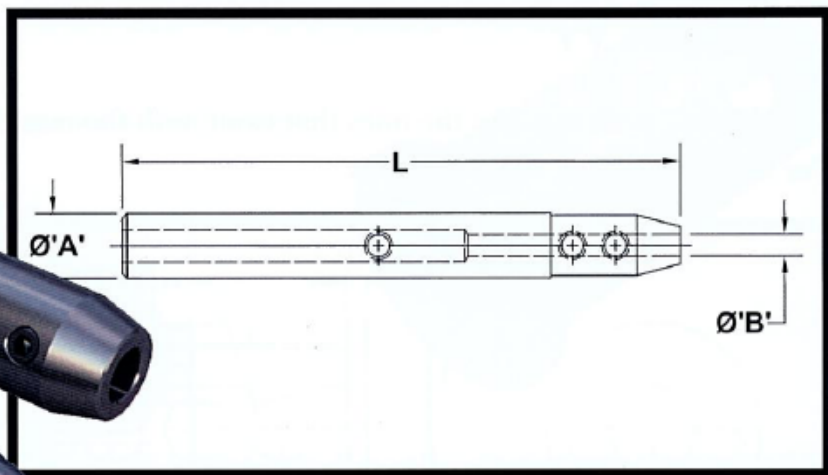

CNC Part Number	BUSHING DIA.	STANDARD BORE	OVERALL LENGTH
	A	B	L
CNC S88-01	3/8	3/32	2.250
CNC S88-03	3/8	1/8	3.250
CNC S88-05	1/2	5/32	3.500
CNC S88-07	1/2	3/16	3.500
CNC S88-09	5/8	1/4	4.250

Special sizes available to your machine specifications: inch-metric, metric-inch, or metric-metric.

Please specify inch or metric O.D. or I.D., when ordering.

Superior Design/Premium Quality

